

PAN-BRAVO-III

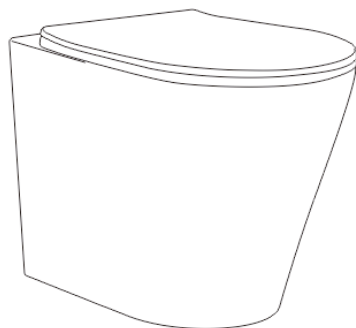
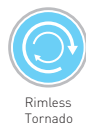

Wall Faced Pan Installation Instructions

Back Inlet Wall Faced Suite Installation

Fit the kee seal and Flush Restrictor onto the protruding inlet pipe. Lubricate both inlet and outlet of pan and push pan back to the wall ensuring both inlet and outlet engage properly with the inlet pipe and outlet connector (Fig 17). insert and secure the fixing screws through the side fixing holes into the floor brackets (Fig 18). Flush and check for leaks. Run a bead of silicone around the foot and back and clean up.

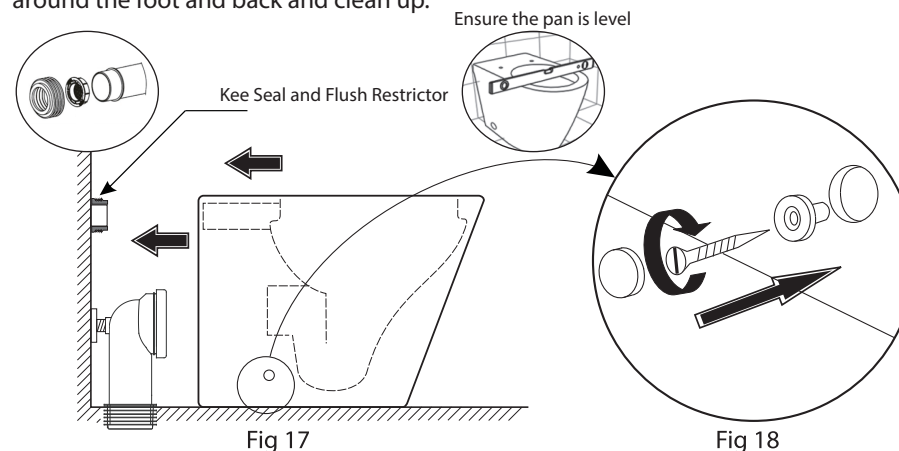

3

Back Inlet Wall Faced Suite Installation

Pre-install the "in wall cistern" according to it's individual installation instructions. Remove the pan from the box. Cut and install the appropriate connector (Fig 15, or Fig 16) and fx floor brackets. Ensure the inlet pipe is protruding 100mm from the finished wall.

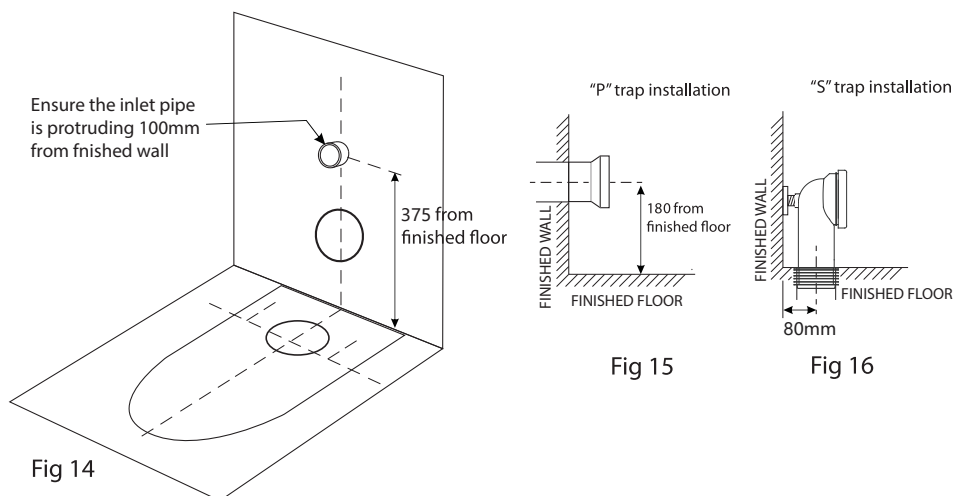

2

Seat Installation

Remove the seat and cover from it's box. Insert the top fixing rawl plugs into the seat bolt holes. Place the hinge blocks, without the stainless steel covers, over the rawl plugs and loosely fix the screw though the hinge blocks into the rawl plugs (Fig 25 and 26) Fit the seat and cover onto the hinge blocks by locating the fixing holes onto the hinge pins and push into place. Close the seat and cover onto the pan, and adjust the position in line with the rim of the pan. Tighten the screws. Open the seat and cover and depress the quick fix buttons to remove the seat and cover. Place the stainless steel covers over the hinge blocks (Fig 27) and replace the seat.

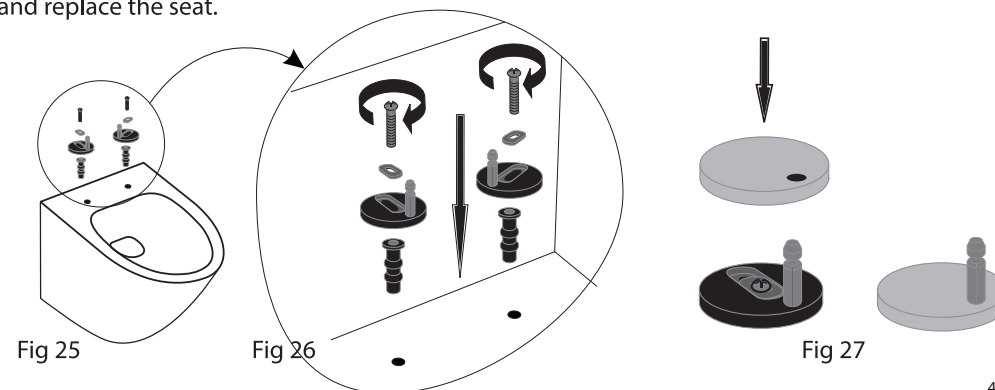

4